

# Sunset Avenue Greenway

## A Stormwater Management Plan for the Historic Morris Brown Campus

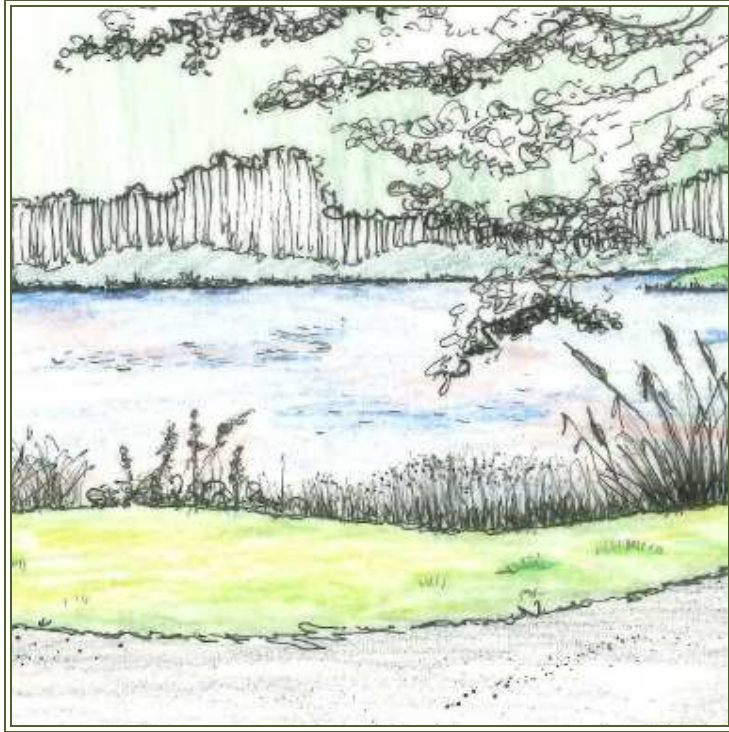

Sunset Avenue Greenway is cited in several other Atlanta University Center (AUC) Conceptual Plans as a significant opportunity to detain, infiltrate, and clean stormwater from the AUC campuses before it impacts local neighborhoods. Extending along Sunset Avenue north of Martin Luther King, Jr. Drive to Magnolia Street, the property is adjacent to Herndon Stadium on the historic Morris Brown

campus. It can capture and detain 5 million gallons of stormwater runoff during a major rain event. It can also infiltrate 490,000 to 1,220,000 gallons of runoff assuming 5 inches per year of infiltration.

Most runoff would enter the park from a stormwater culvert under MLK Jr. Drive. Green infrastructure features, including floodplains, ponds and constructed wetlands, would provide enhanced capacity for stormwater management while also increasing access to greenspace and recreational opportunities for local residents and the AUC community. These outcomes support broader goals identified by both the City of Atlanta Office of Sustainability and the University Community Development Corporation's AUC, Vine City and English Avenue EcoDistrict.

## Sunset Avenue Greenway Site Plan



For some time, the area has been prone to heavy flooding and in 2010 was prioritized in Park Pride's *Proctor North Avenue Green Infrastructure Vision Plan (PNA Study)* as a significant opportunity to capture, infiltrate and clean stormwater. Since then, this concept has garnered commitment from the following collaborative partners:

The Conservation Fund  
The Chattahoochee Riverkeeper  
Community Improvement Association  
Park Pride

PATH Foundation  
Proctor Creek Stewardship Council  
University Center Development Corporation  
West Atlanta Watershed Alliance

The collaborative partners will work together to engage local residents and provide maximum social equity benefits for those who live in the neighborhood. Through a community-driven process, residents will participate in the planning and visioning of the park. The project will include environmental education, workforce training and employment opportunities that support a more sustainable and thriving community for residents, students, and businesses in Westside Atlanta.

### **Layered Benefits**

- Embeds Environmental, Economic and Social Justice outcomes into the design through a community-driven process
- Ensures best use of land that is prone to flooding and less suitable for development
- Increases area capacity to manage stormwater using green infrastructure features
- Improves overall water quality and reduces the impacts of stormwater runoff pollution
- Creates healthy recreation and alternative transportation options for the CAU community and local residents
- Enhances connectivity between AUC and Vine City and creates a destination at the midway point of PATH's Westside Trail
- Creates workforce training and economic development opportunities for area
- Moves forward the goals of Invest Atlanta's Westside TAD Neighborhoods Strategic Implementation Plan, Park Pride's Proctor/North Avenue Green Infrastructure Vision Plan and the ACU, Vine City and English Avenue EcoDistrict Target Cities program
- Supports a more sustainable, healthy and prosperous community for all

The project area to be developed in two phases covers six acres, including 4.2 acres which can be implemented in Phase 1 and 1.7 acres in the Post Office block which can be implemented in Phase 2.

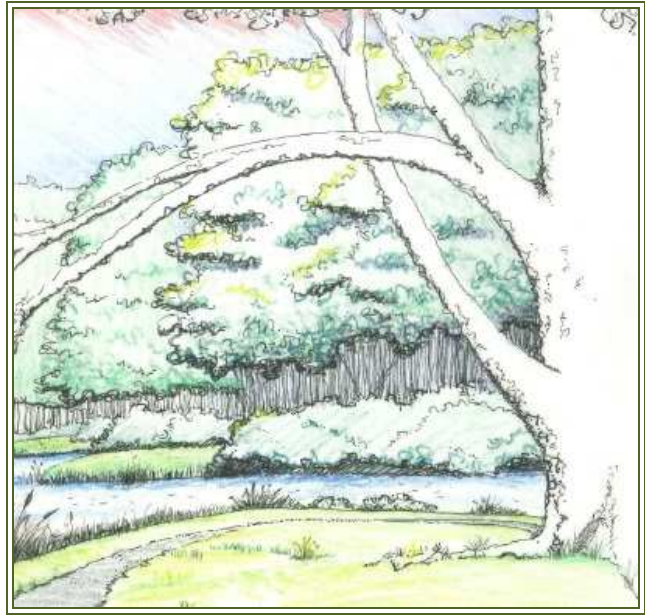

Information on a second green infrastructure complex serving the historic Morris Brown College campus is presented as part of the Catchment 2 Conceptual Plan. It captures runoff from the high elevation area surrounding Fountain Hall in a 300,000 gallon cistern. Excess runoff will cross the Interdenominational Theological Center (ITC) via an ephemeral stream to be detained in the ITC Rain Garden, then from there around the north end of the CAU Stadium and under MLK Jr. Drive to the Sunset Avenue Greenway. See Catchment 2 Conceptual Plan.

The Sunset Avenue Greenway will also capture excess stormwater runoff from the Lawshe Street ephemeral stream discussed in the Catchment 1 Conceptual Plan. The Lawshe Street ephemeral stream will flow down Lawshe Street from Greensferry Avenue towards the CAU Stadium. It will flow only during large rain events when excess stormwater cannot be completely captured by the proposed cisterns and greenspaces.